

Light**FEEL**

# ALUMINUM PROFILE

10 YEARS EXPERIENCE IN LED LIGHTING  
FULL SUPPORT SOLUTIONS



Bend Adlus maximum Band  
Badivs



## SL-ALC1806

Bendable LED Aluminum Profile

### Specification

Material	: Bendable Aluminum AL1806
Match Flexible LED Strips	: Up to 11mm wide.
PC cover	: Frosted, Clear
Finishing	: Silver
Available Lengths	: 2, 3 meters
Dimension	: 18mm x 5.6mm x Length
IP Rating	: IP20
Installation	: Clip lock / 3m tape

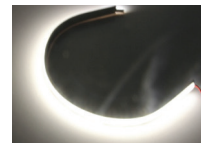
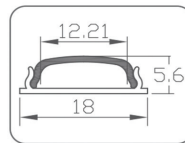

### Accessories



Profile x1

PC Cover x1  
Transparent  
Milky  
Frosted

End Cap x2  
1 with hole  
1 with out hole

Mounting Clip x2



## SL-ALD003C

Surface LED Aluminum Profile

### Specification

Material	: Anodized Aluminum ALD003C
Match Flexible LED Strips	: Up to 16mm wide.
PC cover	: Frosted, Clear
Finishing	: Silver
Available Lengths	: 3 meters
Dimension	: 20.1mm x 19.5mm x Length
IP Rating	: IP20
Installation	: Clip lock

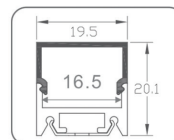

### Accessories



Profile x1

Milky PC Cover x1

End Cap x2  
1 with hole  
1 with out hole

Screws for End Cap x4  
KM2x5H x2

Mounting Clip x2

Steel Rope x1set

## SL-AL1707

### Surface LED Aluminum Profile

#### Specification

Material	: Anodized Aluminum AL1707
Match Flexible LED Strip	: Up to 12mm wide.
PC cover	: Frosted, Clear
Finishing	: Silver, Black
Available Lengths	: 3 meters
Dimension	: 17.4mm x 8.2mm x Length
IP Rating	: IP20
Mounting	: Surface
Installation	: Clip lock

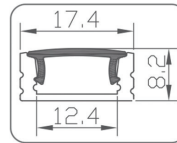

#### Accessories



## SL-AL1616

### Corner LED Aluminum Profile

#### Specification

Material	: Anodized Aluminum AL1616
Match Flexible LED Strip	: Up to 10mm wide.
PC cover	: Frosted, Clear
Finishing	: Silver
Available Lengths	: 3 meters
Dimension	: 16mm x 16mm x Length
IP Rating	: IP20
Mounting	: Surface
Installation	: Clip lock

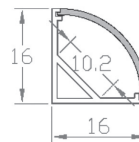

#### Accessories





## SL-AL2810

### Recessed LED Aluminum Profile

#### Specification

Material	: Anodized Aluminum AL2810
Match Flexible LED Strips	: Up to 12mm wide.
PC cover	: Frosted, Clear
Finishing	: Silver
Available Lengths	: 3 meters
Dimension	: 23.7mm x 8.2mm x Length
IP Rating	: IP20
Installation	: Clip lock / Glue

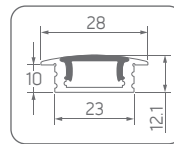

#### Accessories



Profile x1

PC Cover x1  
Transparent  
Milky  
Frosted

End Cap x2  
1 with hole  
1 with out hole

Mounting Clip x2



## SL-AL2507

### Recessed LED Aluminum Profile

#### Specification

Material	: Anodized Aluminum AL2570
Match Flexible LED Strips	: Up to 12mm wide.
PC cover	: Frosted, Clear
Finishing	: Silver
Available Lengths	: 3 meters
Dimension	: 23.5 mm x 9.1 mm x Length
IP Rating	: IP20
Installation	: Clip lock / Glue

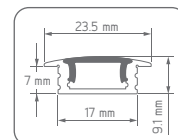

#### Accessories



Profile x1

PC Cover x1  
Transparent  
Milky  
Frosted

End Cap x2  
1 with hole  
1 with out hole

Mounting Clip x2

## SL-AL1110

### Surface LED Aluminum Profile

#### Specification

Material	: Anodized Aluminum AL1110
Match Flexible LED Strips	: Up to 8mm wide.
PC cover	: Frosted, Clear
Finishing	: Silver, Black
Available Lengths	: 3 meters long.
Dimension	: 10.8mm x 10mm x Length
IP Rating	: IP20
Installation	: Magnet or Clip lock

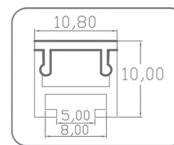

#### Accessories



Profile x1

PC Cover x1  
Transparent  
Milky  
Frosted

End Cop x2  
1 with hole  
1 with out hole

Mounting Clip x2

## SL-AL2121

### Surface LED Aluminum Profile

#### Specification

Material	: Anodized Aluminum AL2121
Match Flexible LED Strips	: Up to 21mm wide.
PC cover	: Frosted, Clear
Finishing	: Silver
Available Lengths	: 3 meters
Dimension	: 21mm x 21mm x Length
IP Rating	: IP20
Installation	: Clip lock

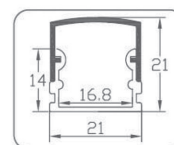

#### Accessories



Profile x1

PC Cover x1  
Transparent  
Milky  
Frosted

End Cop x2  
1 with hole  
1 with out hole

Metal Mounting Clip x2

## SL-AL1202

### Corner LED Aluminum Profile



#### Specification

Material	: Anodized Aluminum AL2102
Match Flexible LED Strips	: Up to 12mm wide.
PC cover	: No
Finishing	: Silver anodized
Available Lengths	: 3 meters
Dimension	: 12mm x 2mm x Length
IP Rating	: non
Installation	: 3M Tape

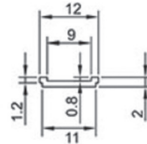

## SL-ALT5

### Recessed LED Aluminum Profile

#### Specification

Material	: Anodized Aluminum ALT5
Match Flexible LED Strips	: Up to 12mm wide.
PC cover	: Frosted, Clear
Finishing	: Silver anodized black
Available Lengths	: 3 meters
Dimension	: Dimension 10mm x Length
IP Rating	: IP20
Installation	: Clip lock

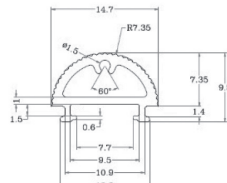

#### Accessories



Profile x1

## Dc track light and Connector (รางประดับระดับ)

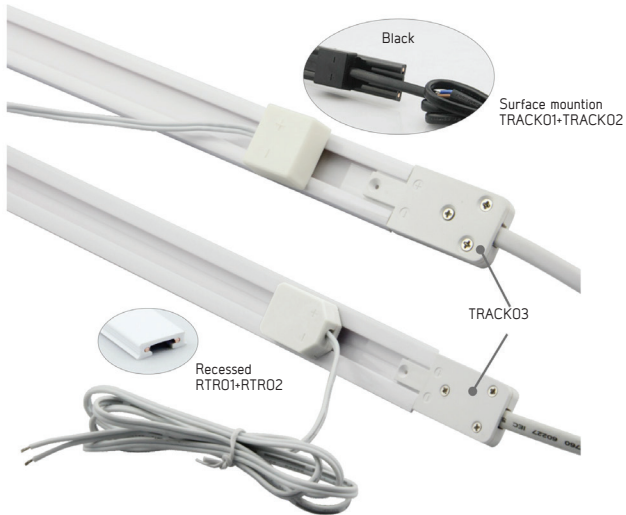

SL-TK01-B  
SL-TK01-W

DC track Light

### Specification

Material	: Plastic + Copper
Finishing	: White or Black
Available Lengths	: 2.5 meters
Dimension	: 21mm x 21mm x Length
Installation	: Surface / Recessed

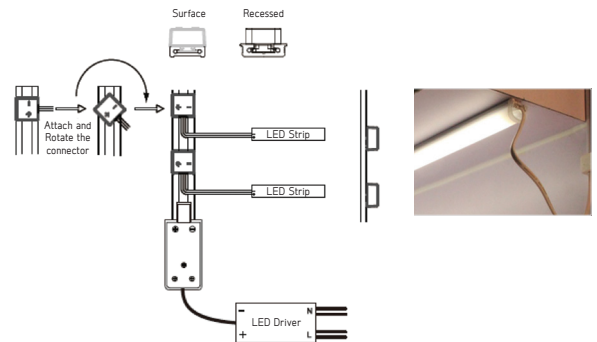

### Accessories



SL-TK02-B [Connector Output]  
SL-TK02-W [Connector Output]

### Specification

Material	: Plastic + Copper
Finishing	: White or Black

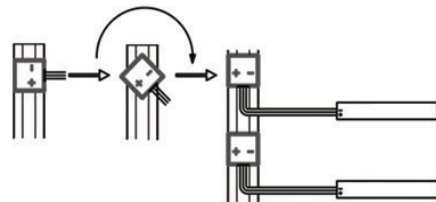

SL-TK03-B [Connector Input]  
SL-TK03-W [Connector Input]

### Specification

Material	: Plastic + Copper
Finishing	: White or Black

SL-TK04-B [End cap]  
SL-TK04-W [End cap]

### Specification

Material	: Plastic + Copper
Finishing	: White or Black